

NOT FOR CONSTRUCTION

| Date     | Issue | Amendment                   |
|----------|-------|-----------------------------|
| 25/01/24 | S     | ISSUED FOR DA APPROVAL      |
| 05/02/24 | T     | Schedule update             |
| 29/02/24 | U     | Floor level corrected       |
| 15/08/24 | V     | Retaining walls             |
| 25/09/24 | W     | Additional details provided |
| 03/10/24 | X     | Amended vehicle swept paths |

| Date     | Issue | Amendment                           |
|----------|-------|-------------------------------------|
| 09/11/23 | M     | Issued for comment                  |
| 09/11/23 | N     | Issued for comment                  |
| 19/12/23 | O     | Issued for comment                  |
| 21/12/23 | P     | Issued for final comment            |
| 24/12/23 | Q     | Awning added to additional drawings |
| 18/01/24 | R     | Issued for comment                  |

| Date     | Issue | Amendment                   |
|----------|-------|-----------------------------|
| 14/09/23 | G     | Survey details incorporated |
| 29/09/23 | H     | Issued for comment          |
| 06/10/23 | I     | Issued for comment          |
| 09/10/23 | J     | Issued for comment          |
| 20/10/23 | K     | Issued for comment          |
| 25/10/23 | L     | Issued for comment          |

| Date     | Issue | Amendment          |
|----------|-------|--------------------|
| 13/04/23 | A     | Issued for comment |
| 13/04/23 | B     | Issued for comment |
| 08/06/23 | C     | Issued for comment |
| 13/07/23 | D     | Issued for comment |
| 24/08/23 | E     | Issued for comment |
| 05/09/23 | F     | Issued for comment |



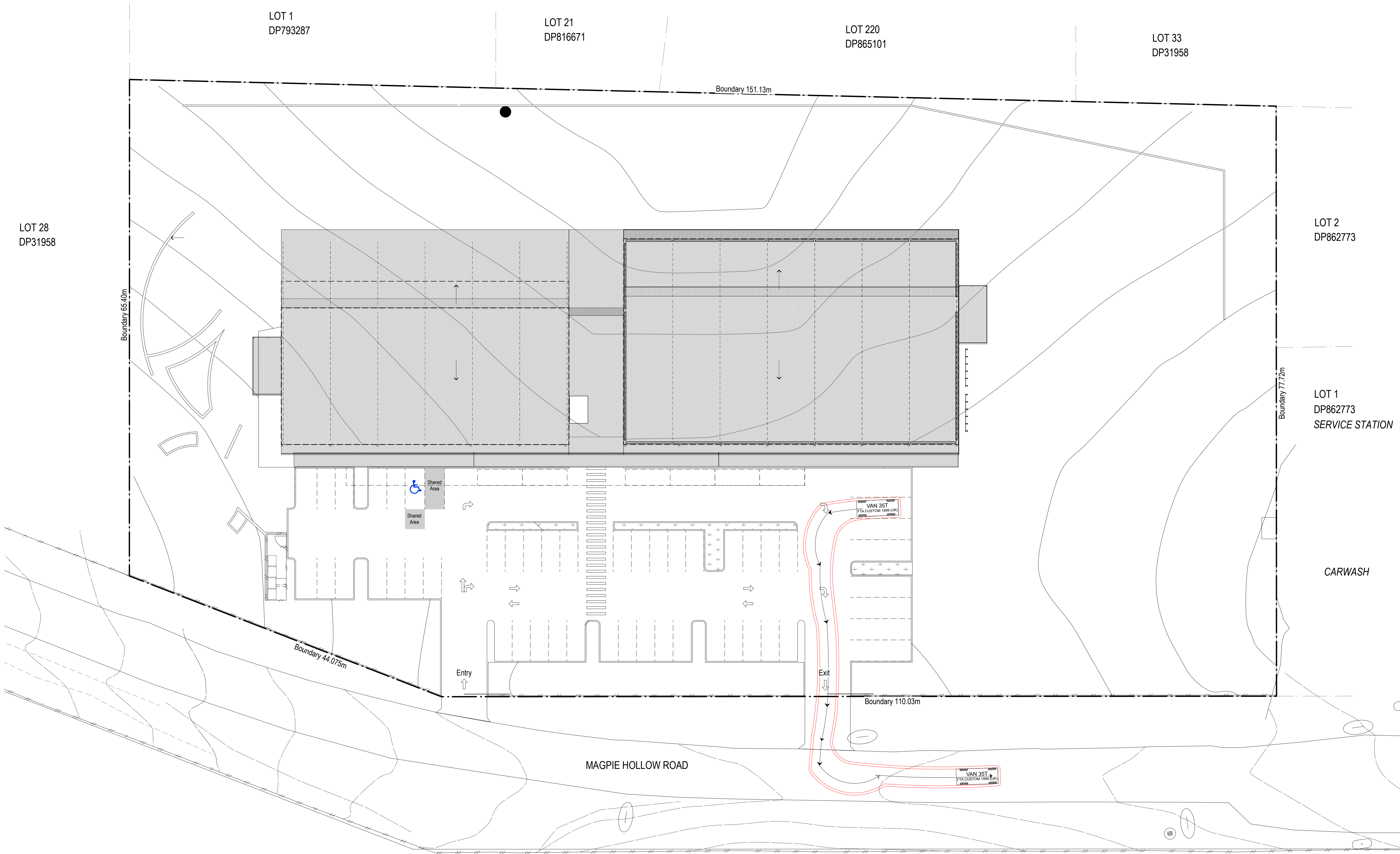

NOT FOR CONSTRUCTION





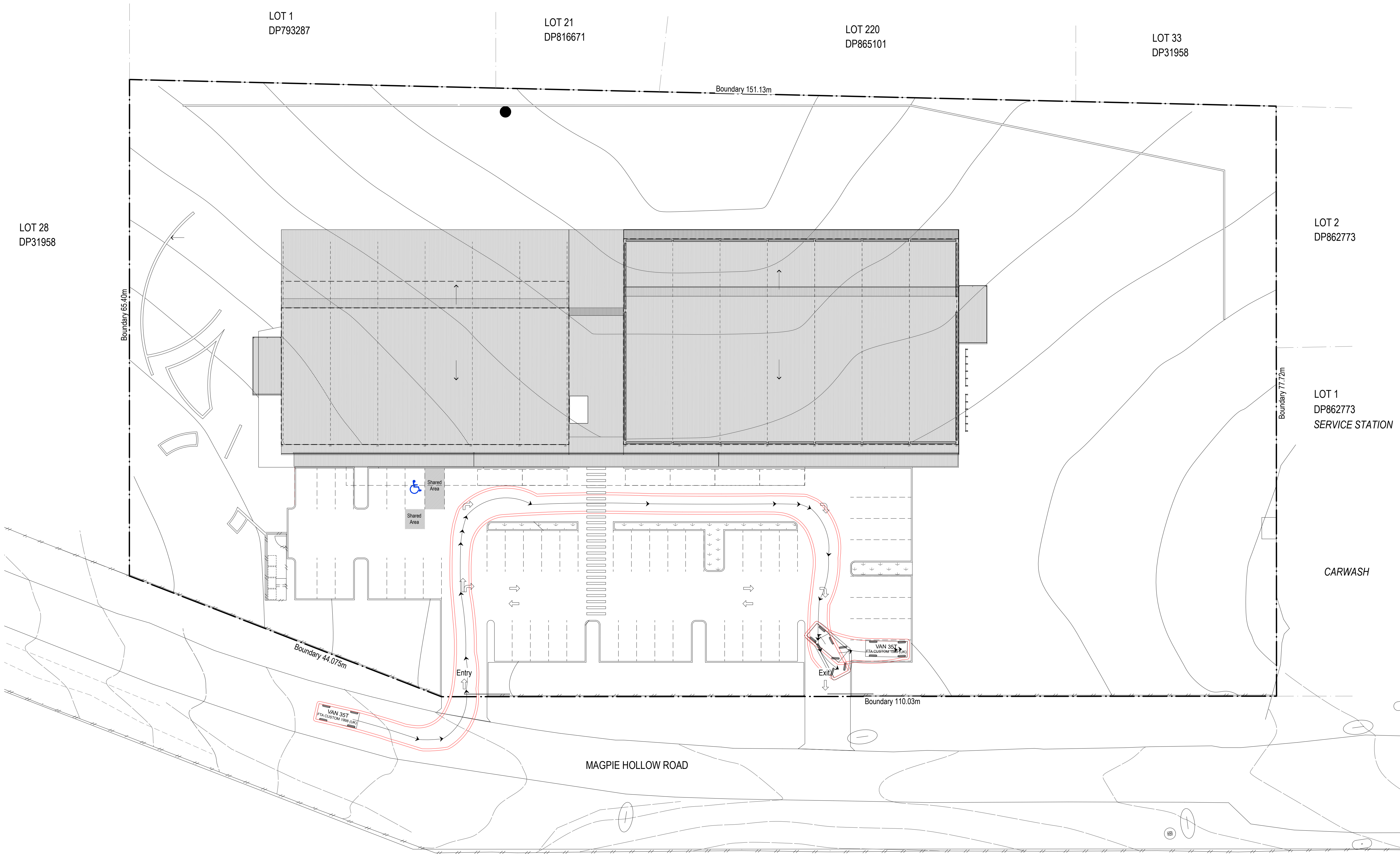

NOT FOR CONSTRUCTION

| Date     | Issue | Amendment                   |
|----------|-------|-----------------------------|
| 25/01/24 | S     | ISSUED FOR DA APPROVAL      |
| 05/02/24 | T     | Schedule update             |
| 29/02/24 | U     | Floor level corrected       |
| 15/08/24 | V     | Retaining walls             |
| 25/09/24 | W     | Additional details provided |
| 03/10/24 | X     | Amended vehicle swept paths |

| Date     | Issue | Amendment                           |
|----------|-------|-------------------------------------|
| 09/11/23 | M     | Issued for comment                  |
| 09/11/23 | N     | Issued for comment                  |
| 19/12/23 | O     | Issued for comment                  |
| 21/12/23 | P     | Issued for final comment            |
| 24/12/23 | Q     | Awning added to additional drawings |
| 18/01/24 | R     | Issued for comment                  |

| Date     | Issue | Amendment                   |
|----------|-------|-----------------------------|
| 14/09/23 | G     | Survey details incorporated |
| 29/09/23 | H     | Issued for comment          |
| 06/10/23 | I     | Issued for comment          |
| 09/10/23 | J     | Issued for comment          |
| 20/10/23 | K     | Issued for comment          |
| 25/10/23 | L     | Issued for comment          |

| Date     | Issue | Amendment          |
|----------|-------|--------------------|
| 13/04/23 | A     | Issued for comment |
| 13/04/23 | B     | Issued for comment |
| 08/06/23 | C     | Issued for comment |
| 13/07/23 | D     | Issued for comment |
| 24/08/23 | E     | Issued for comment |
| 05/09/23 | F     | Issued for comment |



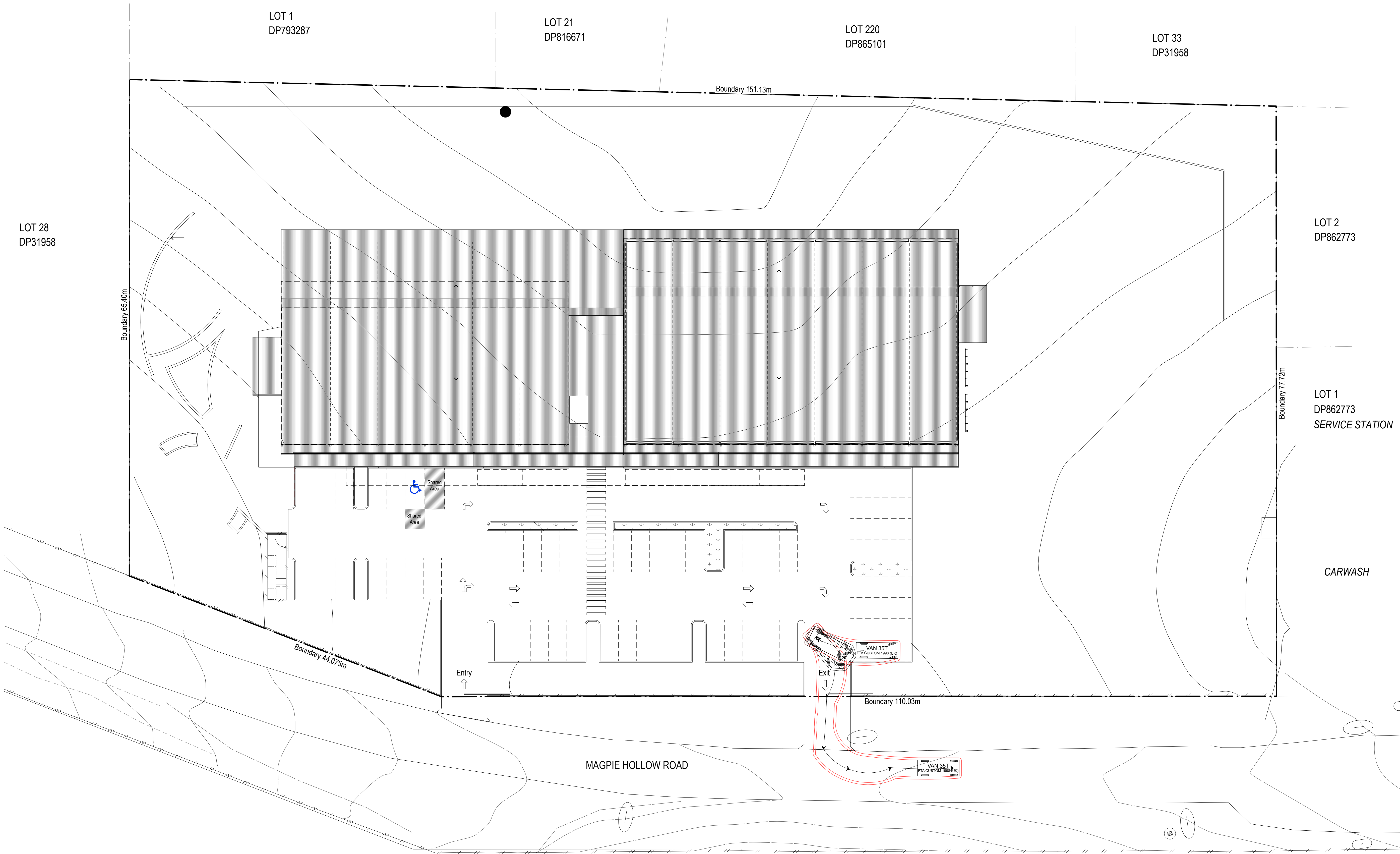

NOT FOR CONSTRUCTION





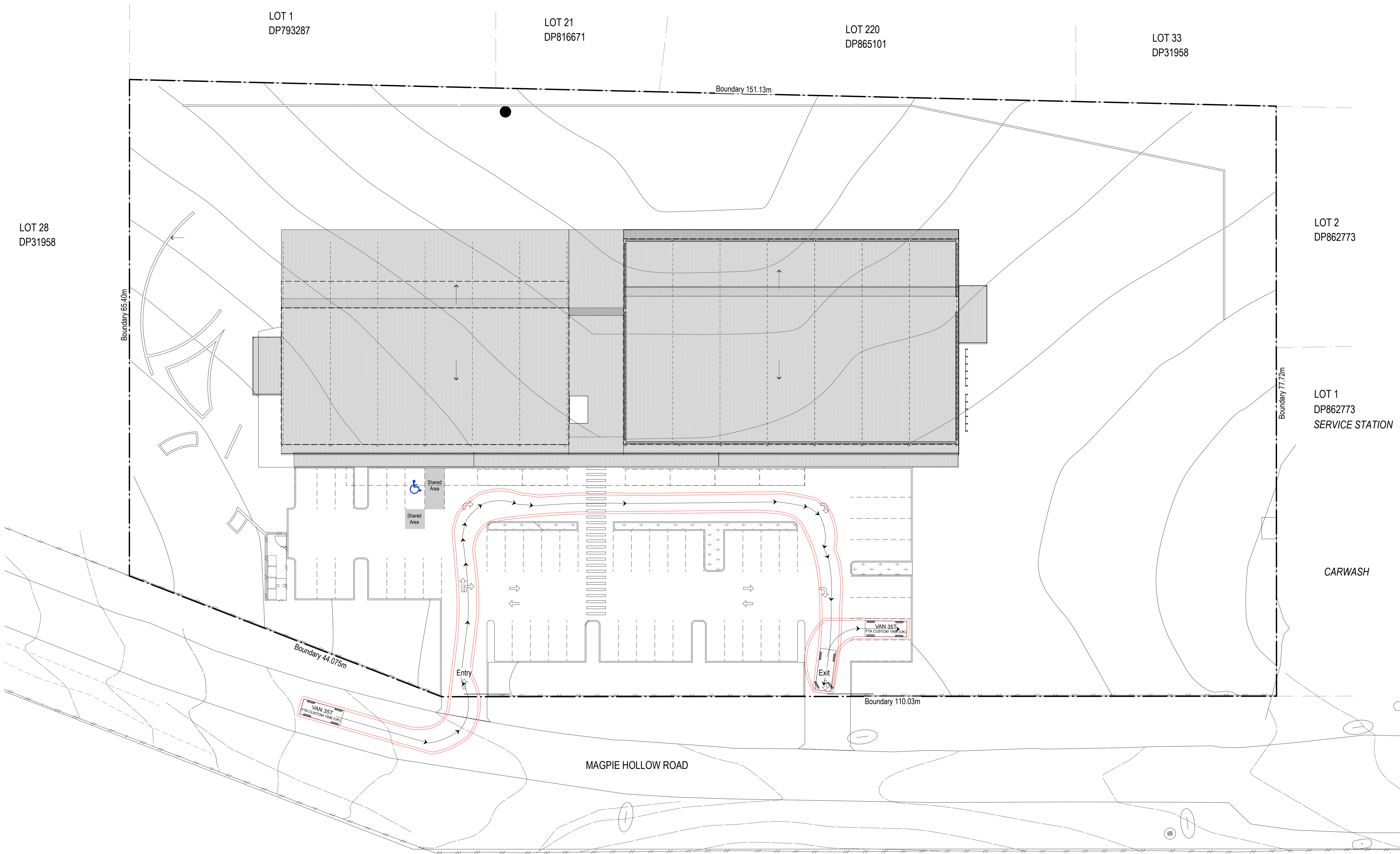

NOT FOR CONSTRUCTION

| Date     | Issue | Amendment                   |
|----------|-------|-----------------------------|
| 25/01/24 | S     | ISSUED FOR DA APPROVAL      |
| 05/02/24 | T     | Schedule update             |
| 29/02/24 | U     | Floor level corrected       |
| 15/08/24 | V     | Retaining walls             |
| 25/09/24 | W     | Additional details provided |
| 03/10/24 | X     | Amended vehicle swept paths |

| Date     | Issue | Amendment                           |
|----------|-------|-------------------------------------|
| 09/11/23 | M     | Issued for comment                  |
| 09/11/23 | N     | Issued for comment                  |
| 19/12/23 | O     | Issued for comment                  |
| 21/12/23 | P     | Issued for final comment            |
| 24/12/23 | Q     | Awning added to additional drawings |
| 18/01/24 | R     | Issued for comment                  |

| Date     | Issue | Amendment                   |
|----------|-------|-----------------------------|
| 14/09/23 | G     | Survey details incorporated |
| 29/09/23 | H     | Issued for comment          |
| 06/10/23 | I     | Issued for comment          |
| 09/10/23 | J     | Issued for comment          |
| 20/10/23 | K     | Issued for comment          |
| 25/10/23 | L     | Issued for comment          |

| Date     | Issue | Amendment          |
|----------|-------|--------------------|
| 13/04/23 | A     | Issued for comment |
| 13/04/23 | B     | Issued for comment |
| 08/06/23 | C     | Issued for comment |
| 13/07/23 | D     | Issued for comment |
| 24/08/23 | E     | Issued for comment |
| 05/09/23 | F     | Issued for comment |



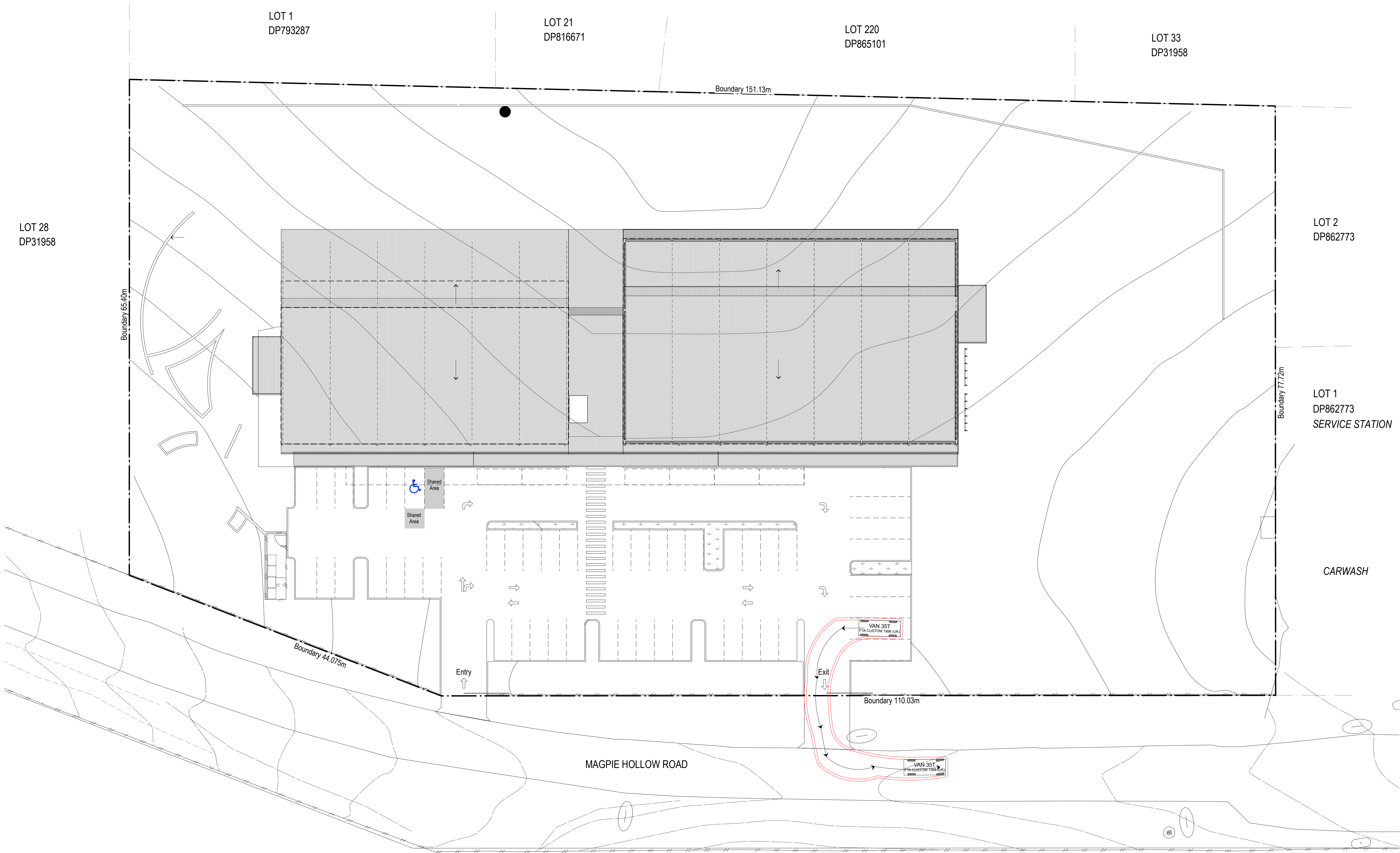

NOT FOR CONSTRUCTION

| Date     | Issue | Amendment                   |
|----------|-------|-----------------------------|
| 25/01/24 | S     | ISSUED FOR DA APPROVAL      |
| 05/02/24 | T     | Schedule update             |
| 29/02/24 | U     | Floor level corrected       |
| 15/08/24 | V     | Retaining walls             |
| 25/09/24 | W     | Additional details provided |
| 03/10/24 | X     | Amended vehicle swept paths |

| Date     | Issue | Amendment                           |
|----------|-------|-------------------------------------|
| 09/11/23 | M     | Issued for comment                  |
| 09/11/23 | N     | Issued for comment                  |
| 19/12/23 | O     | Issued for comment                  |
| 21/12/23 | P     | Issued for final comment            |
| 24/12/23 | Q     | Awning added to additional drawings |
| 18/01/24 | R     | Issued for comment                  |

| Date     | Issue | Amendment                   |
|----------|-------|-----------------------------|
| 14/09/23 | G     | Survey details incorporated |
| 29/09/23 | H     | Issued for comment          |
| 06/10/23 | I     | Issued for comment          |
| 09/10/23 | J     | Issued for comment          |
| 20/10/23 | K     | Issued for comment          |
| 25/10/23 | L     | Issued for comment          |

| Date     | Issue | Amendment          |
|----------|-------|--------------------|
| 13/04/23 | A     | Issued for comment |
| 13/04/23 | B     | Issued for comment |
| 08/06/23 | C     | Issued for comment |
| 13/07/23 | D     | Issued for comment |
| 24/08/23 | E     | Issued for comment |
| 05/09/23 | F     | Issued for comment |

**Proposed School**  
**DEZIGN**  
Lot 1 Magpie Hollow Road South Bowenfels



**Vehicle Swept Paths**  
**DACC 24**  
Issue: X  
Scale: 1:250 @ A1

Date: 03/10/24  
Project: BMD222389